

TIMBERLINE

344 x 313 x 271 cm

ASSEMBLING INSTRUCTIONS

English

EN



Table of Contents

1. Preparing for installation	3
1.1. Important notes	3
1.3. Foundation	4
1.4. Anchoring the sauna	4
1.2. Maintenance and cleaning	4
1.5. Tools required	5
1.6. Parts list	6
2. Floor plan / Foundation	9
2.1. Floor plan left	9
2.2. Floor plan right	10
3. View / Dimensions	11
3.1. View left	11
3.2. View right	11
4. Assembling the cabin	12
4.1. Mounting the base frame	12
4.2. Mounting the cabin walls	12
4.3. Mounting the door	12
4.4. Mounting the window	12
4.5. Mounting the floor and cover strips	12
4.6. Assembling the internal roof	12
4.7. Assembling the benches and backrest	13
4.8. Assembling the bench rail/ heater guard	13
4.9. Assembling the outer roof	13
4.10. Assembling the terrace	13
4.11. Mounting the corner strips and ventilation grills	13
4.12. Mounting the privacy grids	13

1. Preparing for installation

Read these assembly instructions carefully and keep them in a safe place, so that you can look up product information at any time.



These assembly instructions can also be found on our website:
www.almostheaven.com

1.1. Important notes

- Inquire with your local building authority (municipal office, municipal authority) regarding the construction guidelines and load standards.
- A solid concrete foundation is important for the durability and safety of the outdoor sauna. For you, we recommend the foundation to be done by an expert.
- You need an assistant for the installation.
- All screw fittings must be pre-drilled.



Attention!

The electrical connection may only be performed by a qualified electrician or similarly qualified person.

- Roofing material is not included in your sauna kit. You will need to obtain roofing materials from your local supplier or home center.
- Wood is a natural product that can swell, shrink or warp, despite good storage. For this reason, some force may be necessary during the installation.
- The wood of the outdoor sauna is untreated. In order to increase the lifespan, we recommend to treat the outside with a suitable wood-protective colour.
- Do not treat the wood on the saune interior.

1.2. Maintenance and cleaning

- The sauna should be cleaned with a damp cloth. Only use warm water – no cleaning products.
- We recommend heating the cabin once a month if the sauna is not used for a long time.



You are likely to find pitch pockets in some of the wood pieces.

The leaking pitch can be removed with a rag soaked in acetone. If only droplets of pitch occur, allow these to harden and then carefully scrape them off with a knife.

1.3. Foundation

You can support your sauna with a full concrete slab of 3-4” in thickness (recommended) or obtain treated 4*4 timbers to support the saune kit. In either case, be sure the surface is level prior to installation of the sauna kit.

1.4. Anchoring the sauna

If you are assembling your sauna in area with high winds, we suggest you appropriately secure the sauna to sauna surface.

1.5. Tools required

- Hammer with a wooden head or a mallet
- Cordless screwdriver with bits for cross-head screws and Torx
- Tape measure
- Drill bits with a diameter of 3 mm, 10 mm, 20 - 30 mm
- Level
- Utility knife
- Ladder
- Hand saw
- Approximately 4 tubes of construction adhesive



This symbol indicates tips and useful information

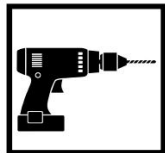

Pre-drill



Cut to real measurement with backsaw



Check the right angle:

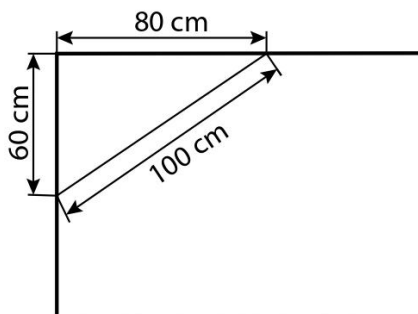

Handle glass with care: Special care must be taken with the edges of the glass – hardened glass can shatter into small pieces in the event of impact. Insert protective cushioning (e.g: cardboard box) under the edge of the glass.

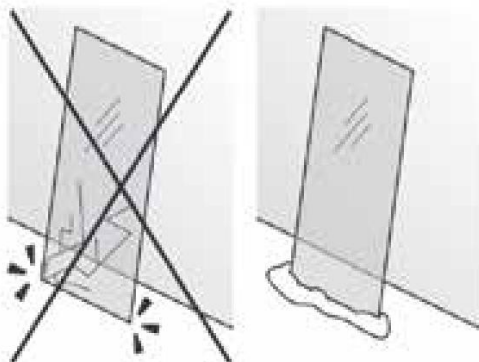

1.6. Parts list

No. of items	Name	Dimensions mm
Base frame		
2	Bottom timber (impregnated)	1910x146x40
2	Bottom timber (impregnated)	1990x146x40
W1: Side wall with door		
14	Timber	1085x146x40
1	Timber crossing the door	1910x146x40
1	Timber upper triangle	1910x397x40
W2: Rear wall		
14	Timber	1990x146x40
1	Timber (cutout air supply)	1990x146x40
1	Timber upper 82°	1930x480x40
W3: Side wall		
15	Timber	1910x146x40
1	Timber (cutout air supply)	1990x146x40
1	Timber upper triangle	1910x397x40
W4: Front wall with window		
12	Timber	1990x146x40
1	Timber under window	1990x146x40
1	Timber crossing the window	1990x146x40
6	Timber beside window	118x146x40
1	Timber upper 82°	1990x146x40
Floor		
7	Floor frame (impregnated)	1905x100x40
20	Floor boards	1900x95x19
1	Cover strips	1900x20x25
2	Cover strips	1910x20x25
1	Cover strips	780x20x25
1	Cover strips	1055x20x25
Door		
1	Door	1900x820x50
1	Door frame cover inside	800x55x20
1	Door frame cover inside	1950x55x20
2	Door frame cover outside	780x55x20
1	Door frame cover outside	1955x55x20

No. of items	Name	Dimensions mm
Window		
1	Window glass	1741x496x16
2	Window frame	1805x560x16
Corner covers		
8	Corner covers	1000x80x20
2	Corner covers	1630x80x20
2	Corner covers 82°	1630x80x20
2	Corner covers	1360x80x20
2	Corner covers 82°	1360x80x20
Roof inside		
1	Roof panel	1890x955x55
1	Roof panel	1890x955x55
1	Roof support laths 82°	1910x40x40
1	Roof support lath	1910x40x40
2	Roof support laths 82°	1847x40x40
Roof outside		
4	Roof rafters	2060x130x40
4	Roof rafters	1580x130x40
19	Roof tongue and groove boards	1024x95x19
19	Roof tongue and groove boards	2096x95x19
18	Roof tongue and groove boards	1586x95x19
19	Roof tongue and groove boards	1534x95x19
4	Roof fascia boards	1475x40x40
2	Roof fascia boards 82°	1965x40x40
2	Roof fascia boards 82°	1475x130x40
1	Roof fascia board support slat 82°	1965x130x40
1	Roof fascia board support slat 82°	1607x150x20
1	Roof fascia board support slat 82°	1534x150x20
1	Roof fascia board support slat 82°	1740x150x20

No. of items	Name	Dimensions mm
Interior		
2	Bench support slats	495x88x28
2	Bench support slats	900x88x28
2	Bench	1900x500x88
1	Backrest	1900x220x48
2	Heater safety guard	1000x88x28
1	Heater safety guard	490x70x28
1	Heater safety guard	675x70x28
1	Heater safety guard	575x70x28
Terrace		
5	Base frame	1210x95x40
3	Base frame	2000x95x40
3	Base frame	1375x95x40
16	Floor boards	825x120x25
5	Floor boards	815x120x25
5	Floor boards	805x120x25
5	Floor boards	2000x120x25
5	Floor boards	2010x120x25
1	Cover boards	825x95x25
2	Cover boards	1408x95x25
2	Grid	1970x1100x40
1	Grid	1970x805x40
1	Roof support post	2550x70x70
1	Roof support post	2550x50x30
1	Roof support post	2180x50x30
1	Roof support post	2320x50x30
Accessories		
2	Air vent grill with insect screen	250x250x30
2	Sauna ventilation cover 620P	215x170x20
1	Installation material set	
1	Assembling instruction	

2. Floor plan / Foundation

2.1. Floor plan left

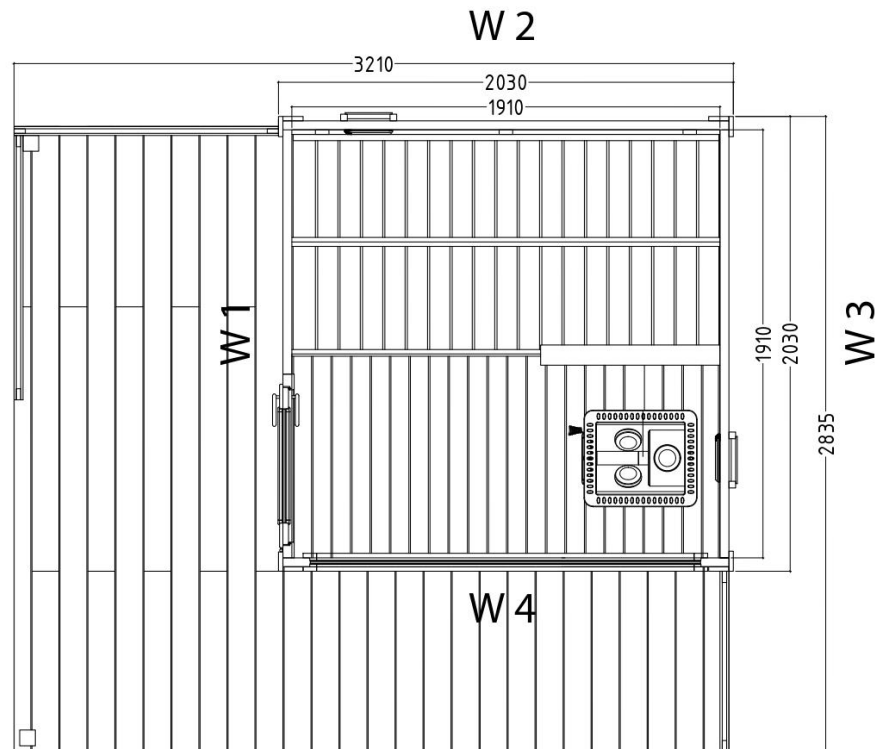

Your sauna can be assembled with a „left“ or „right“ floor-plan as shown. The instructions are given with a „left“ floor-plan, so be sure to invert accordingly if you assemble in the „right“ configuration.

2.2. Floor plan right

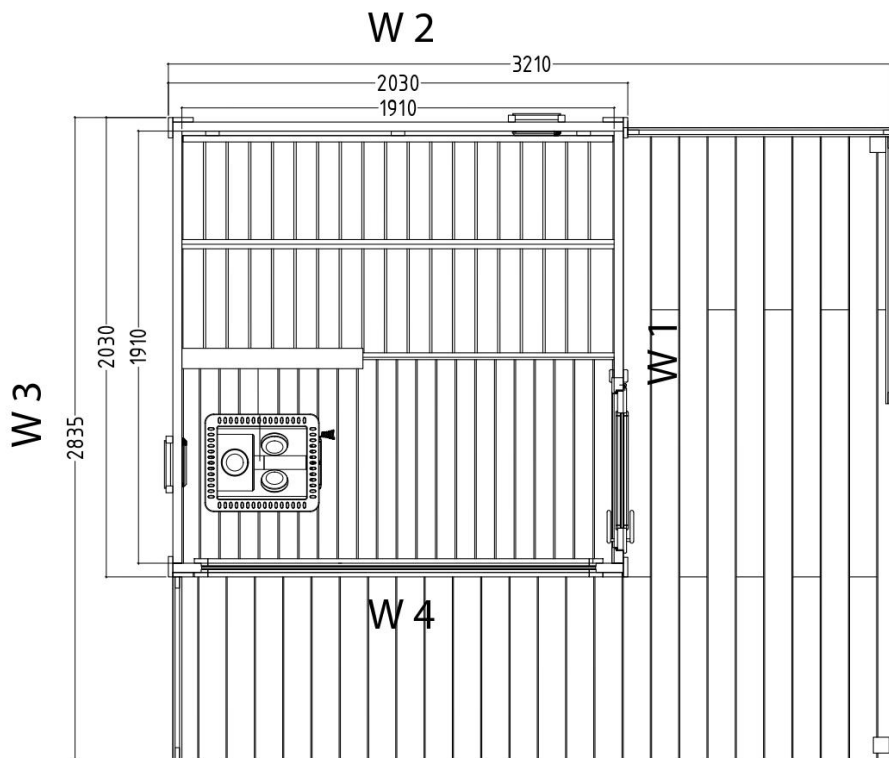

3. View / Dimensions

3.1. View left

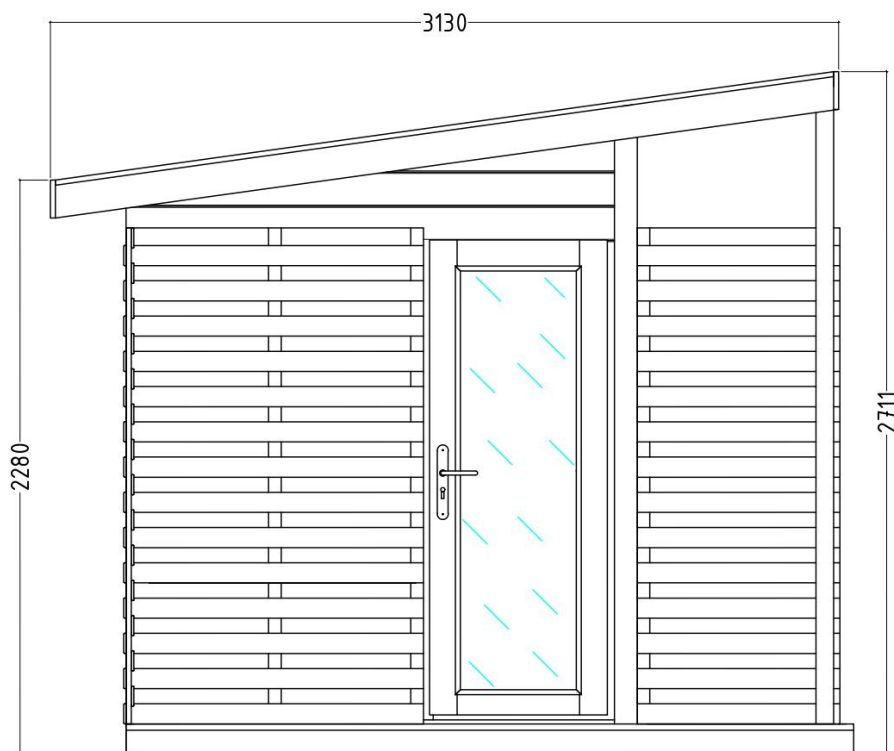

3.2. View right

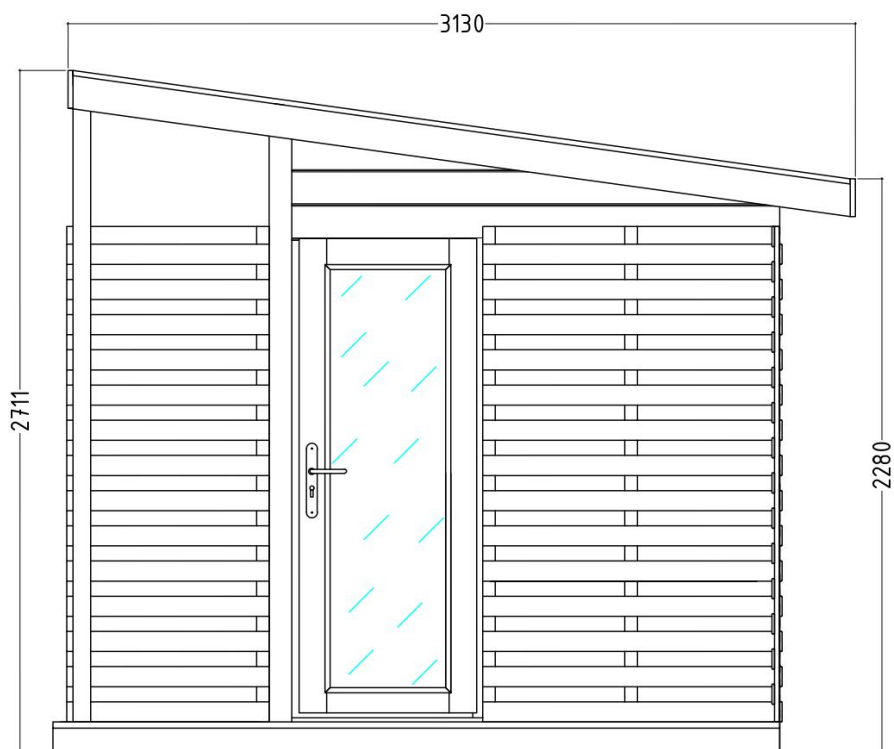

4. Assembling the cabin

**ATTENTION!**

Note the floor plan on page 10 or 11 and the illustrations from page 15 onwards.

4.1. Mounting the base frame

Lay the base frame on to the foundation as shown in the floor plan and in the foundation displays (see page 10, 11 and 12). Glue the floor frames together at the corners and screw the parts using 5 x 90 mm screws.

4.2. Mounting the cabin walls

Start with the assembly of the log planks on the back wall. Proceed row-wise. As done in case of base frame, screw the corners. Hammer the dowel nails into the drilled holes in every row. If you are not assembling in a high-wind area it is not necessary to use the metal dowels.



Check the right angle before screwing the wall elements together. Observe the tip on page 4.

Note the position of the ventilation slides in the 2nd and 14th row.

4.3. Mounting the door

Place the door in the door opening and screw the timbers from the outside to the door frame. Then mount the outer and inner door frame covers.

4.4. Mounting the window

First place a window frame inside and then screw it in. Install the glass from outside in and mount the outside window frame. Install the vent covers as shown.

4.5. Mounting the floor and cover strips

Install the floor supports as shown and screw into the outside base frame.

4.6. Assembling the internal roof

Mounting of the roof supporting ledges. Distance to the top edge: 210 mm. Insert the two roof elements.

4.7. Assembling the benches and backrest

4.8. Assembling the bench rail/ heater guard

Place the rafters into the recesses according the diagram shown and note the distance of the overhang. Screw the rafters to the logs. Screw the tongue and groove roof boards to the rafters. Next install the 40x40 pieces to the underside of the roof boards, noting the angle place on the edge of the 40x40 board. Next install the fascia pieces to the 40x40 boards around the perimeter of the roof. Install the shingles of your choice (not included) on the top of the sauna roof.

4.9. Assembling the outer roof

Note the distance of the overhang screw the tongue and groove roof boards to the rafters.

Install the 40x40 pieces to the roof pieces and then install the fascia pieces. Note the cut angle of the 40x40 pieces.

The roofing (not included) must be installed as per the instructions of the manufacturers.

4.10. Assembling the terrace

Lay the base frame of the terrace as shown in the photos (see page 26) and screw it to the base frame of the cabin. Then mount the cover boards on the base frame. Mount the floor boards.

4.11. Mounting the corner strips and ventilation grills

4.12. Mounting the privacy grids

4.1.

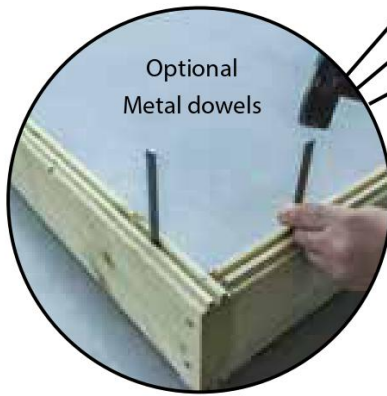
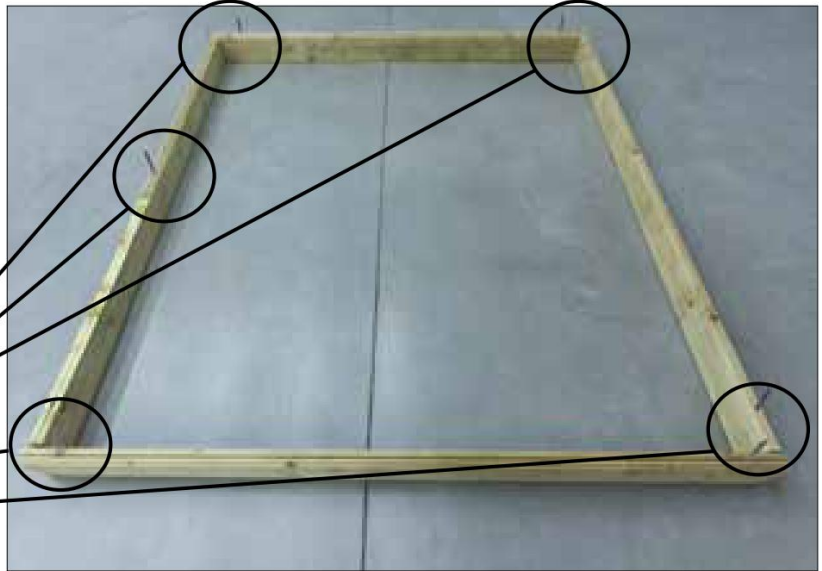
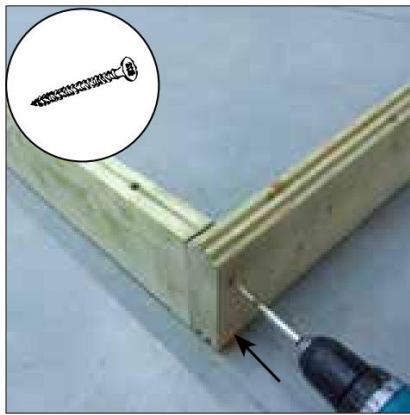
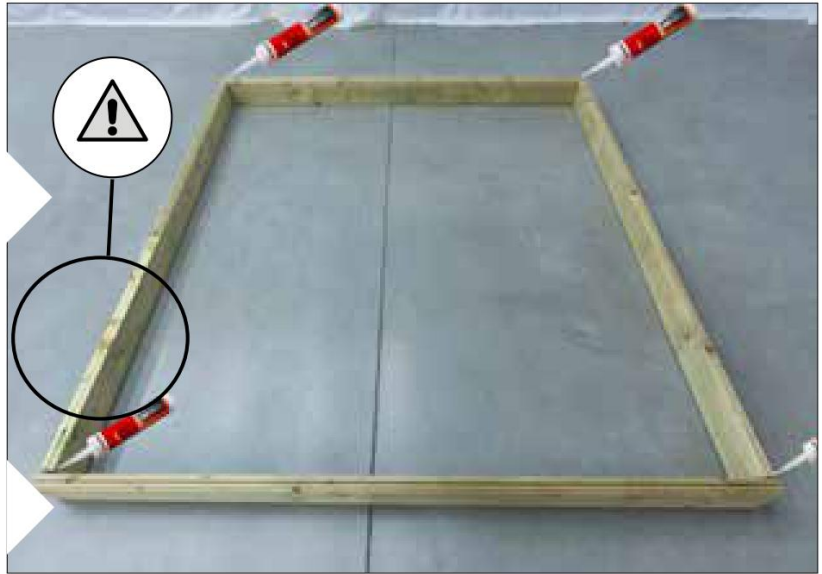

4.2.

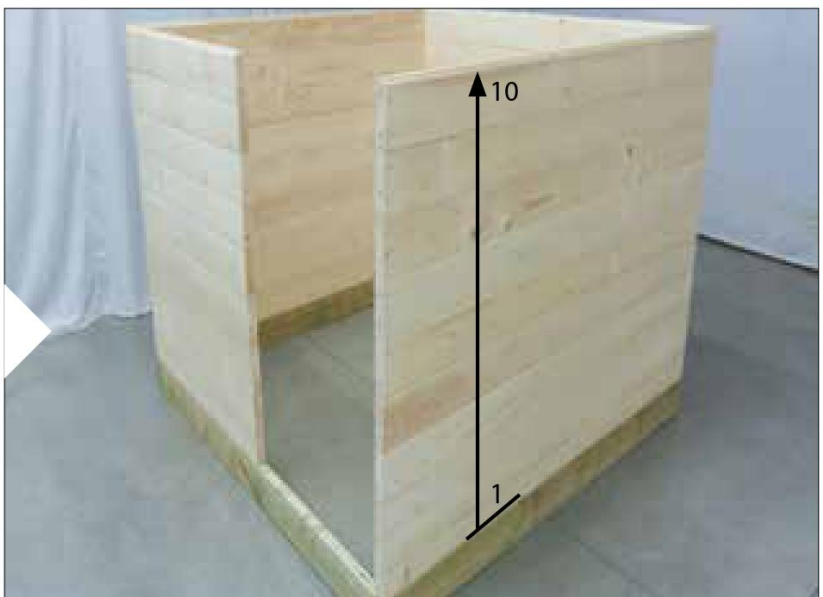
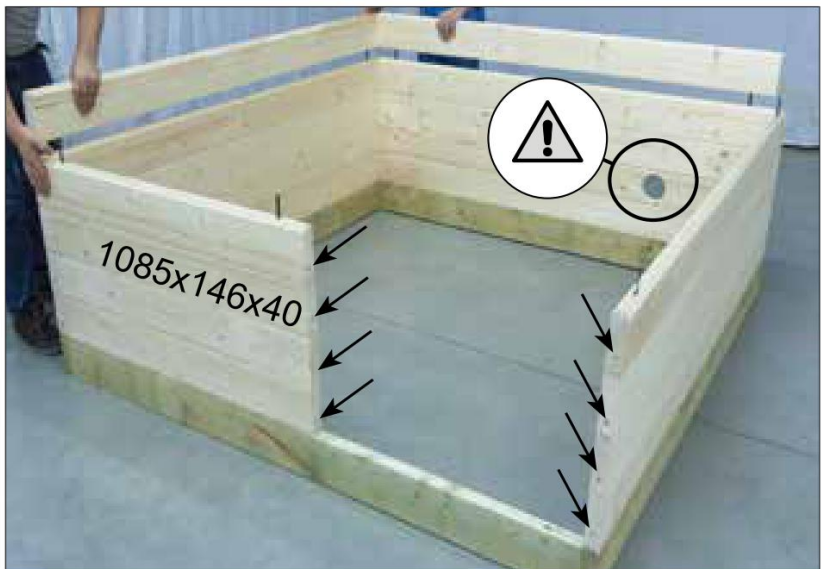
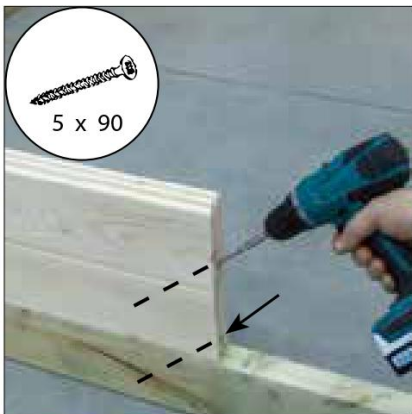
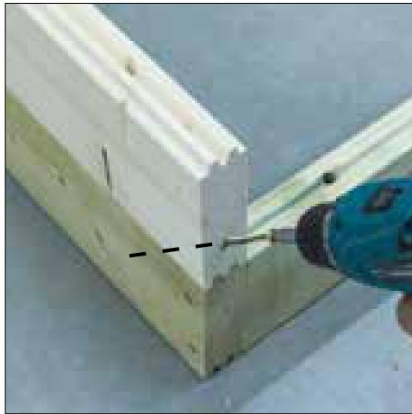



4.3.

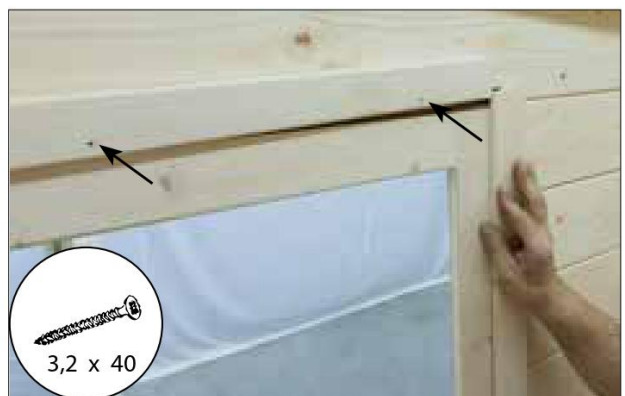

4.4.

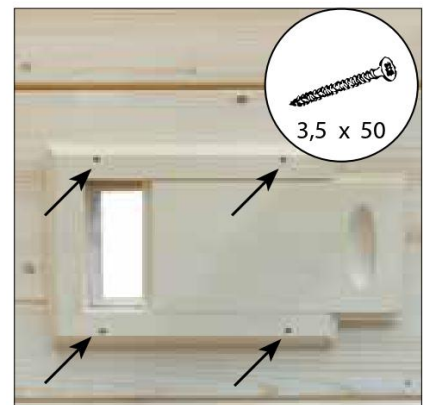

4.5.

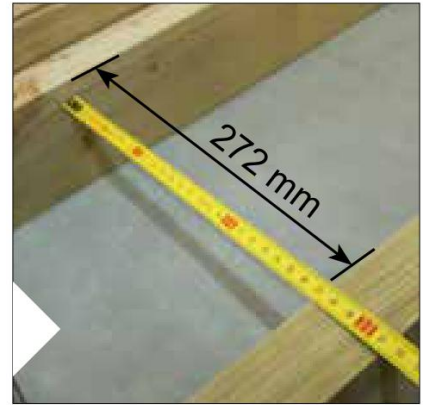

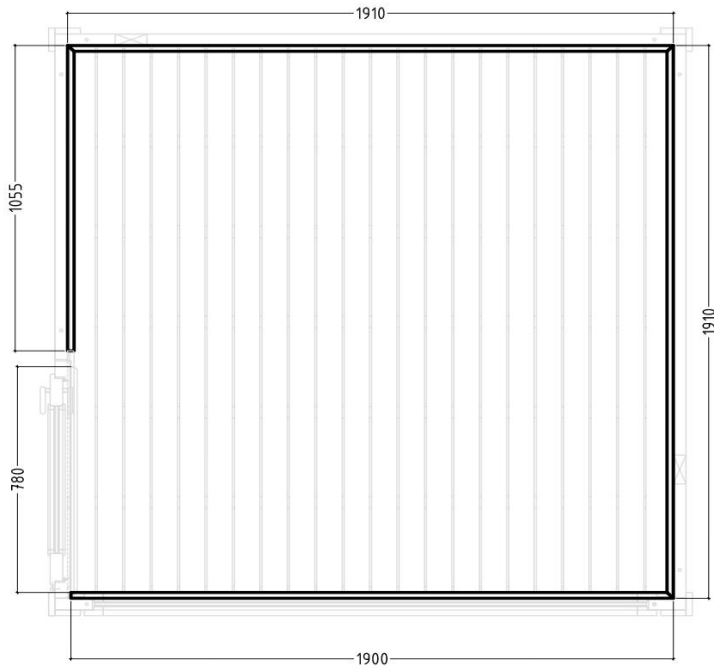

4.6.

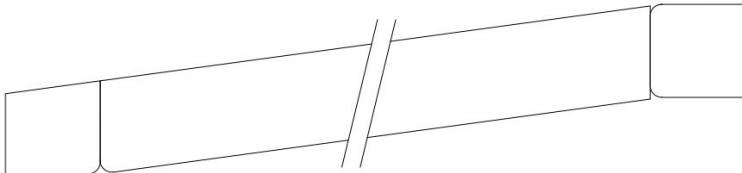
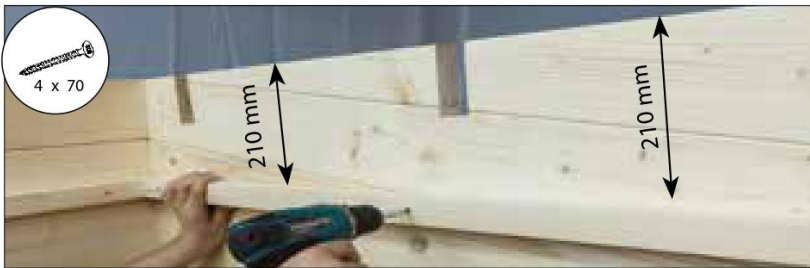

4.7.

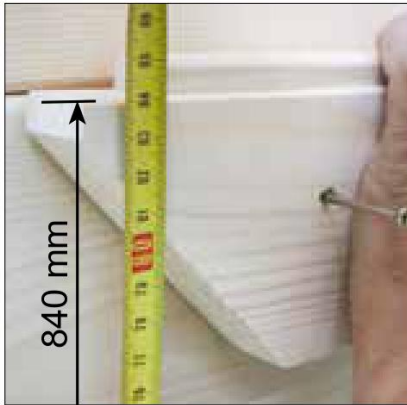

4.8.



4.9.

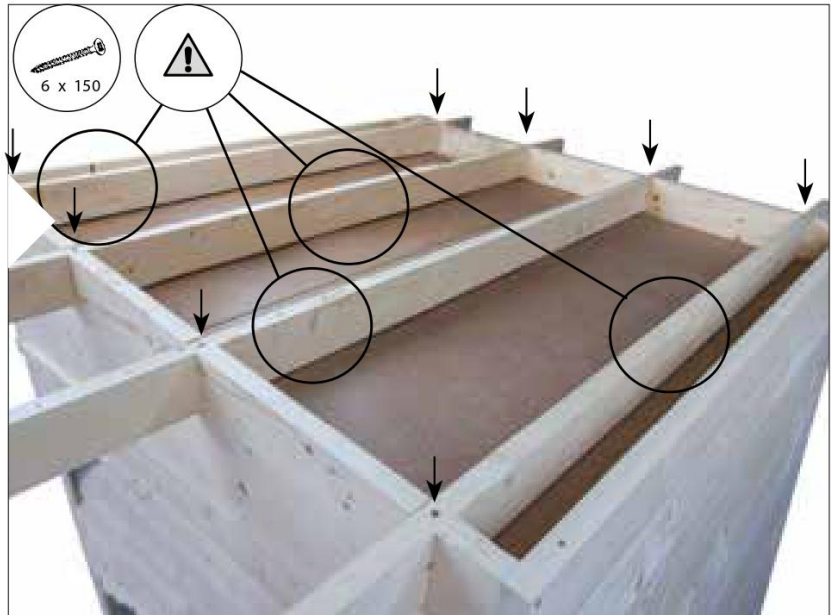
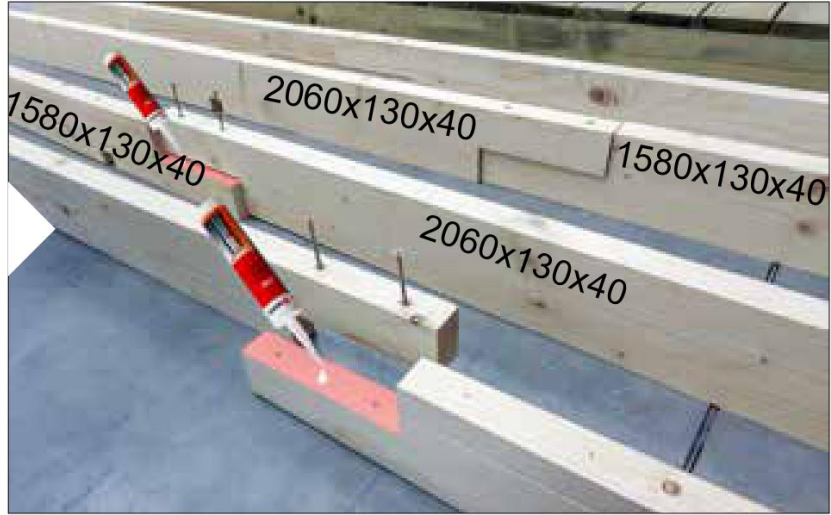
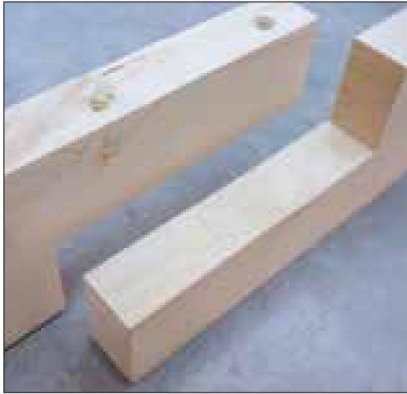

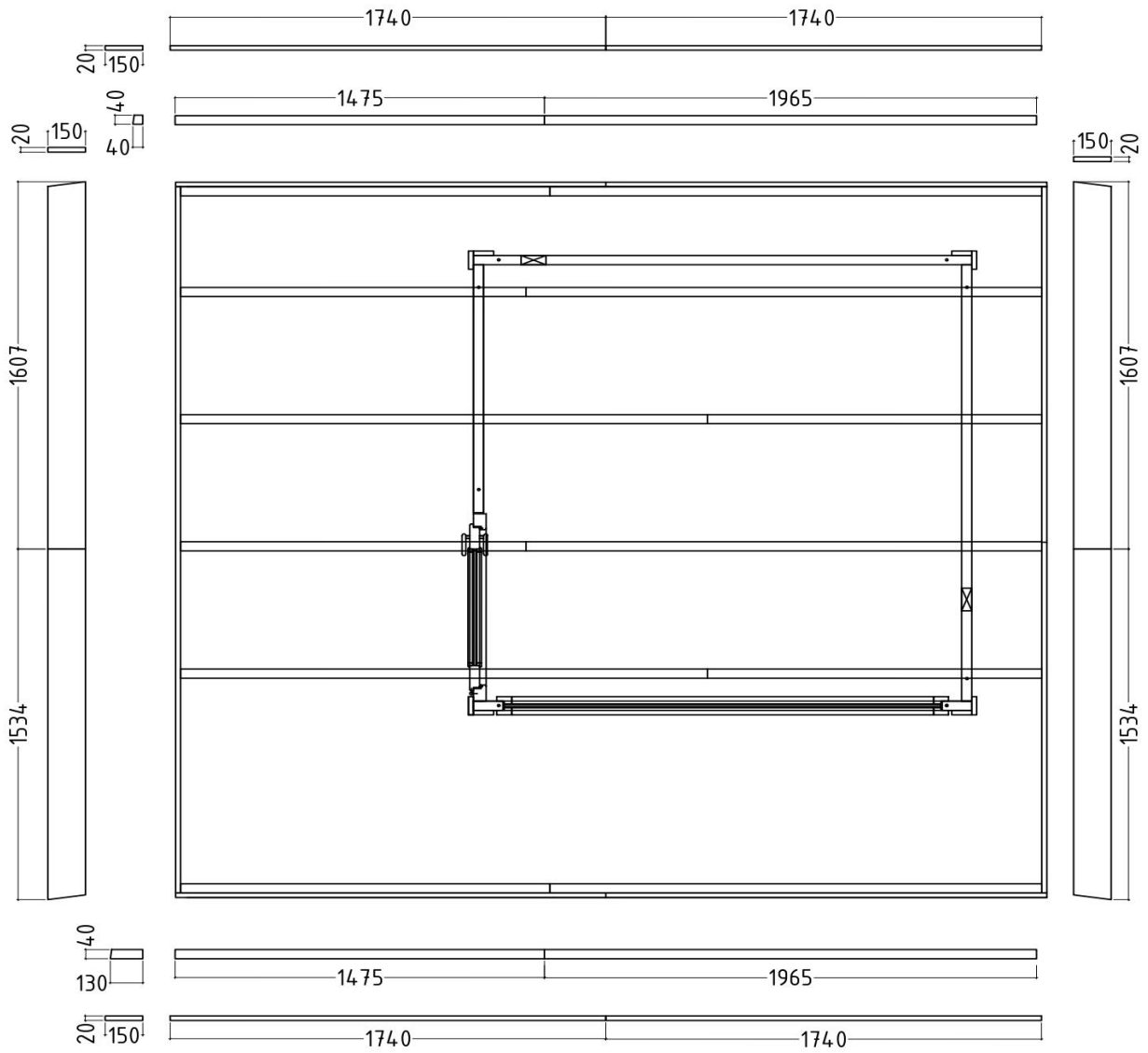

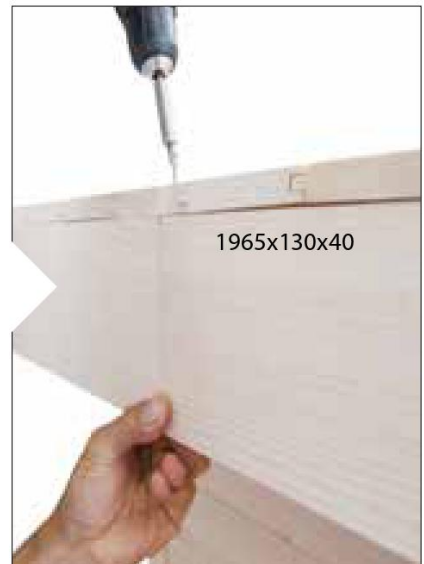
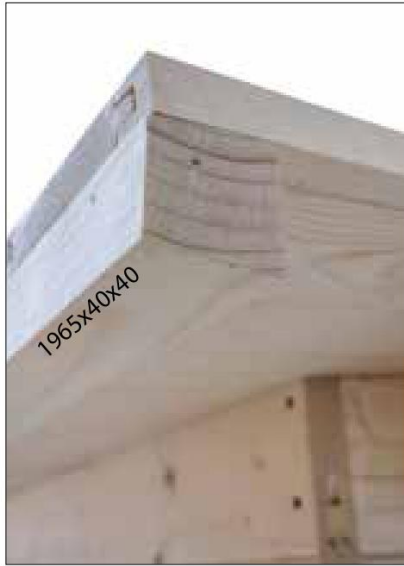

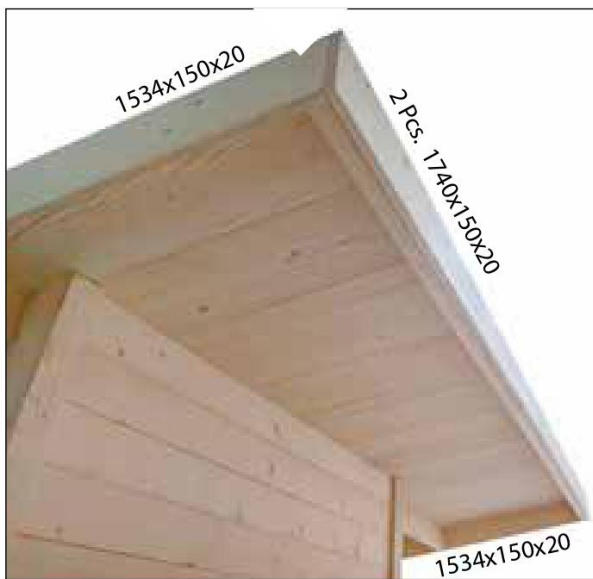

4.10.

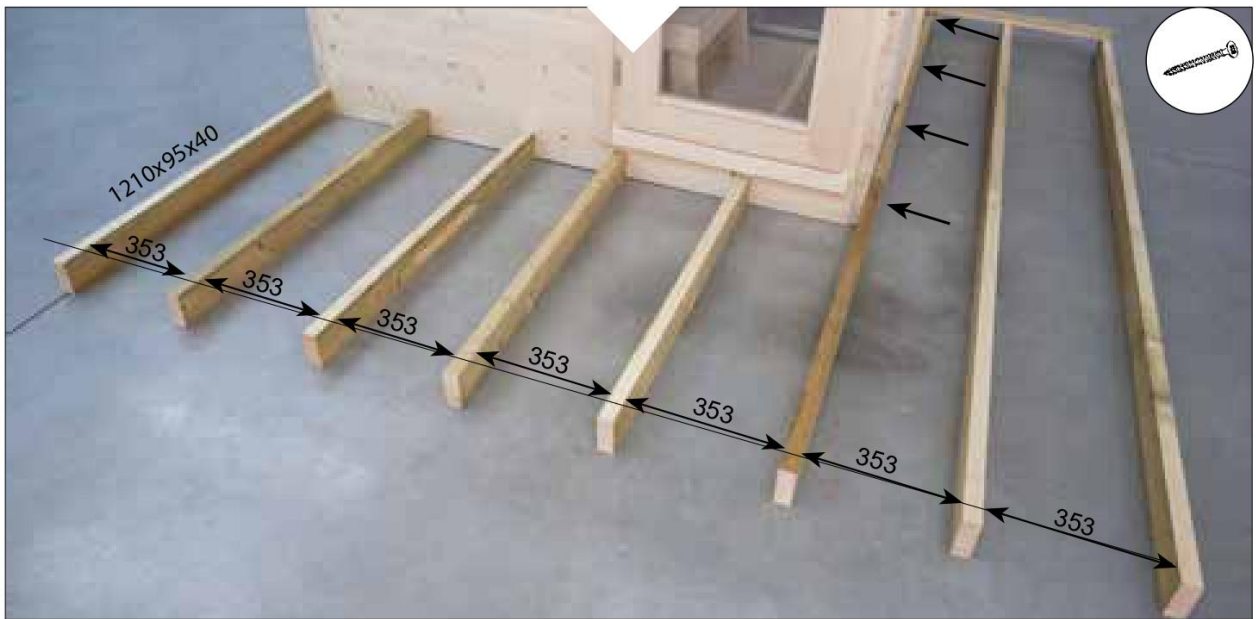
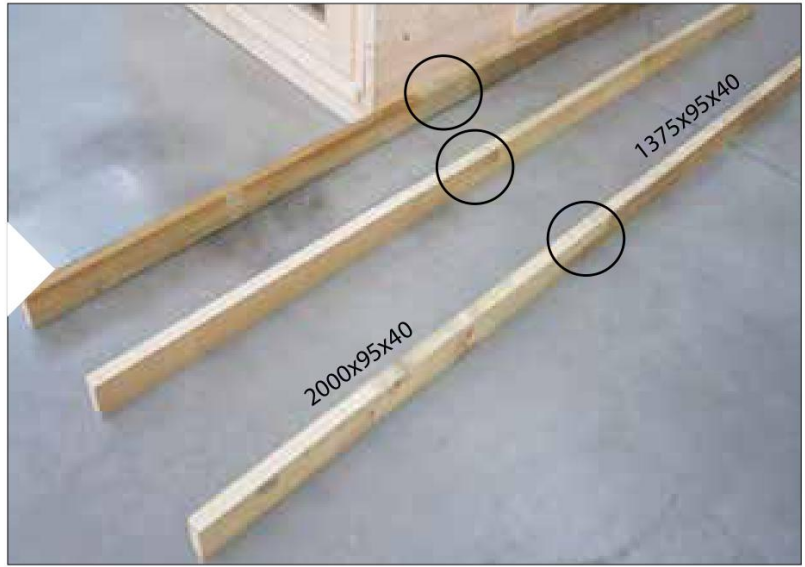



4.11.

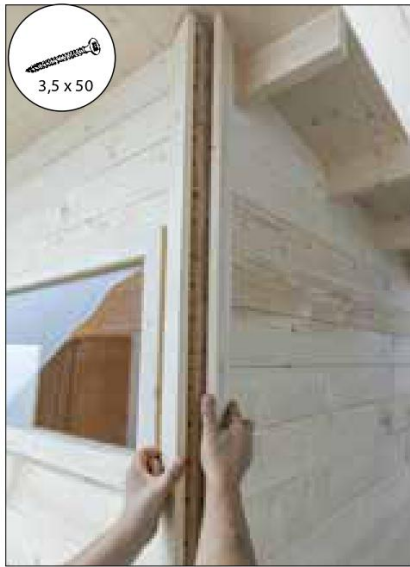

4.12.

